

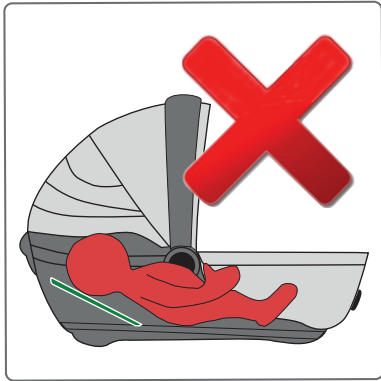

22-42

INDY

40



41

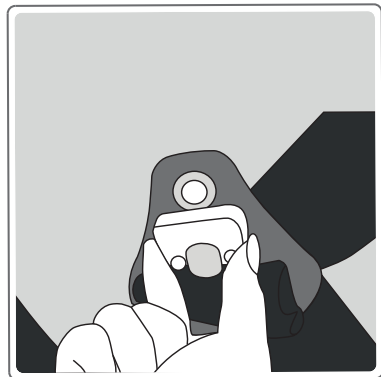

42

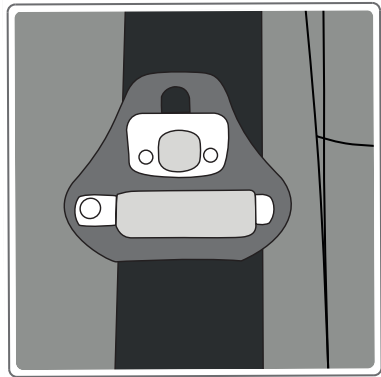

43-51

INDY

49

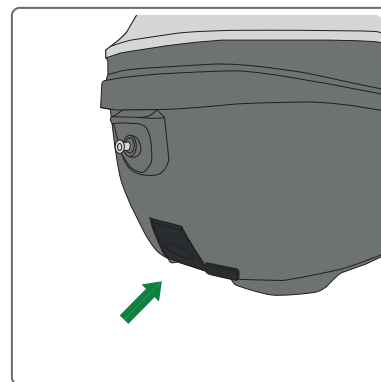

50

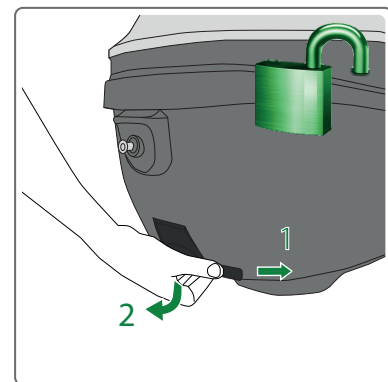

51

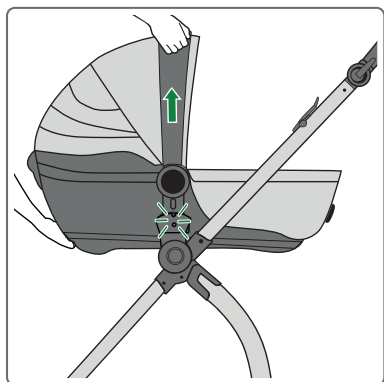

43-51

INDY

43

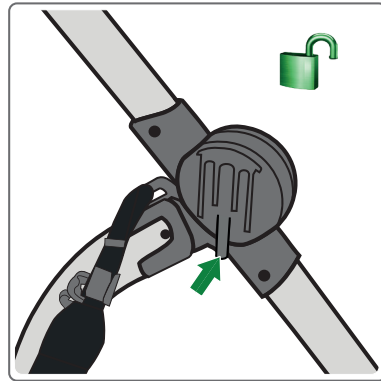

44

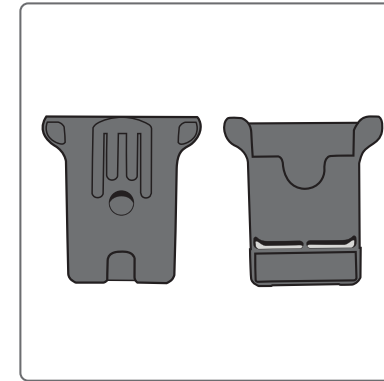

45



46



47

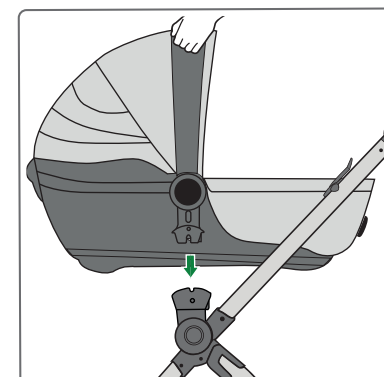

48

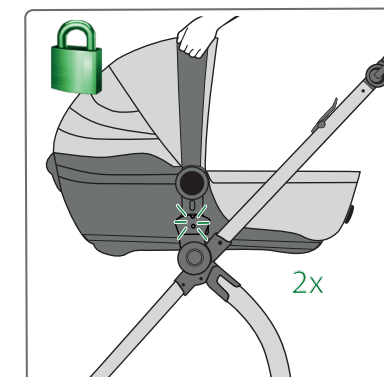

52-60

INDY

58

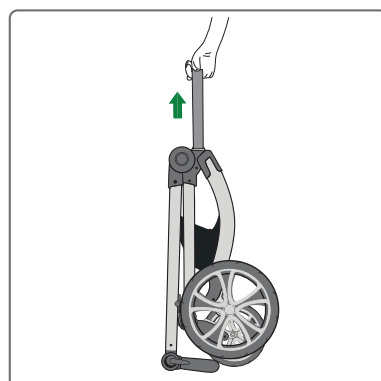

59

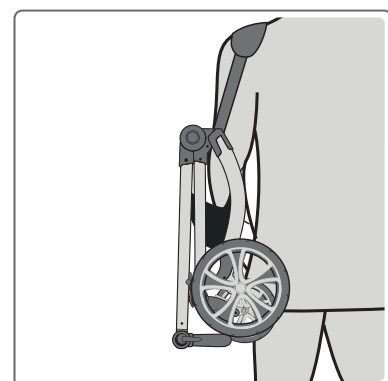

60

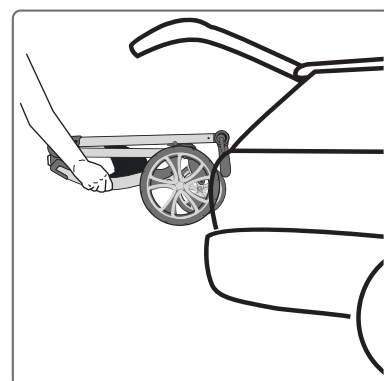

52-60

INDY

52



53



54



55

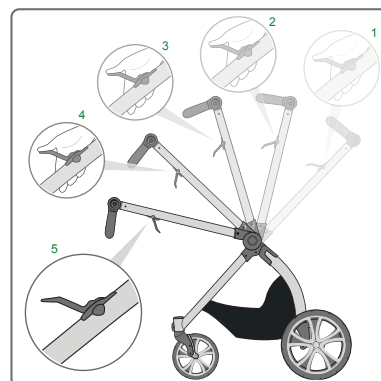

56



57

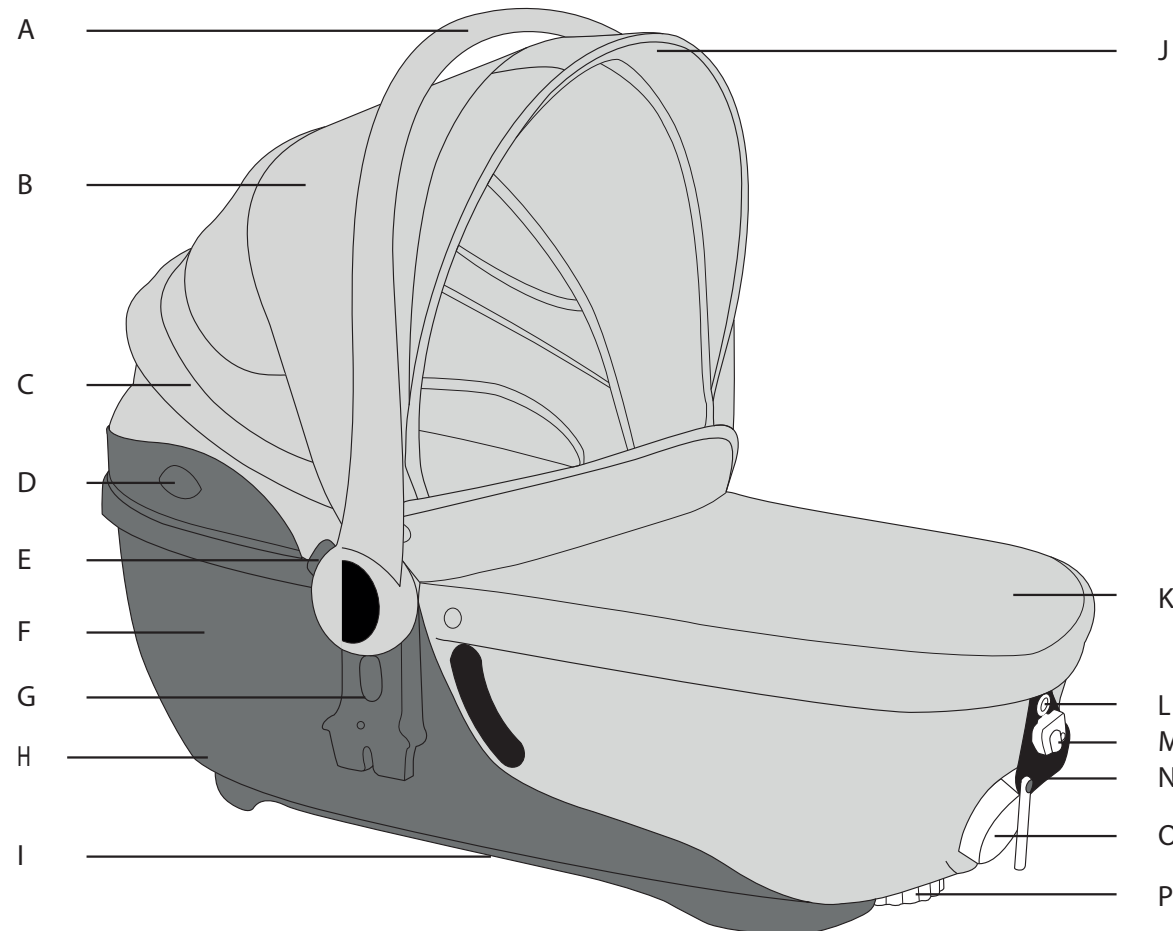
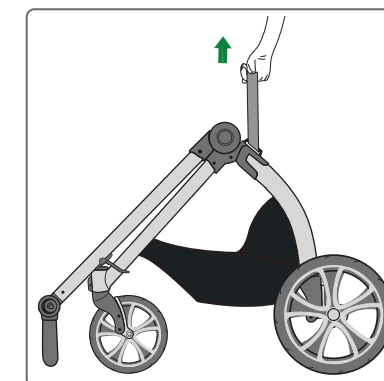

 **INDY**  
 INNOVATIVE . NEW . DESIGNED . YOUNG .

 **INDY**  
 INNOVATIVE . NEW . DESIGNED . YOUNG .

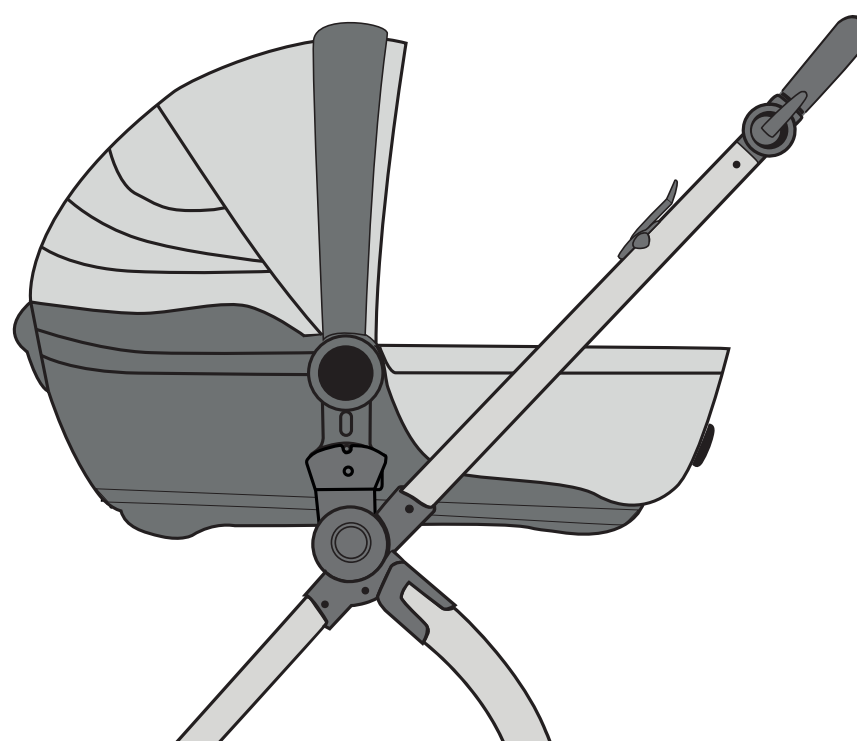

**BUBBLE**  
 www.gesslein-indy.de



1-3

INDY

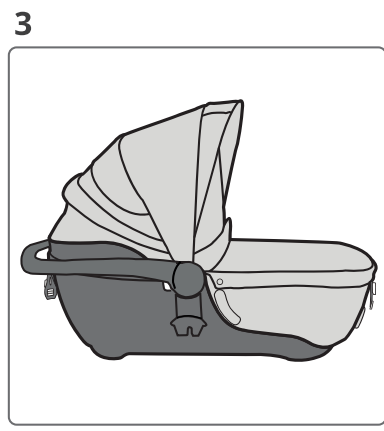
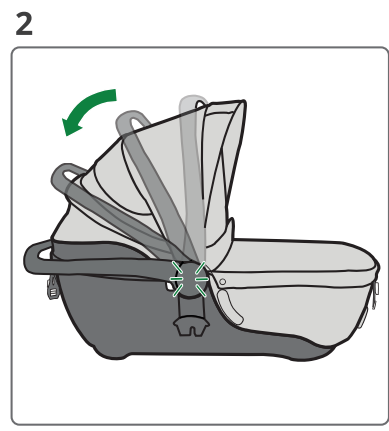
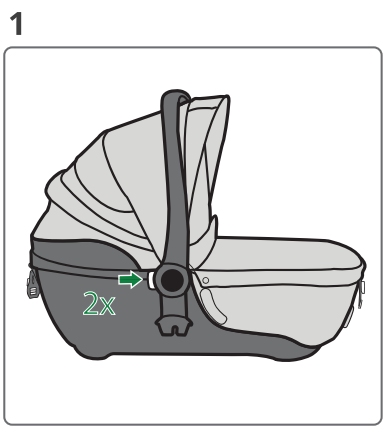

4-11

INDY

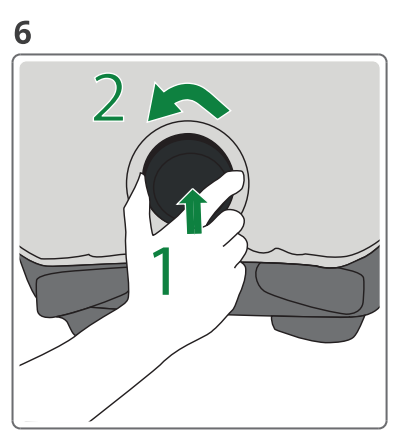
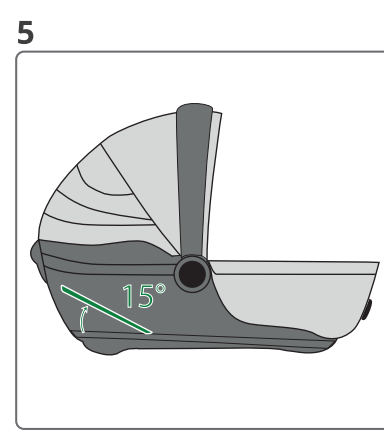
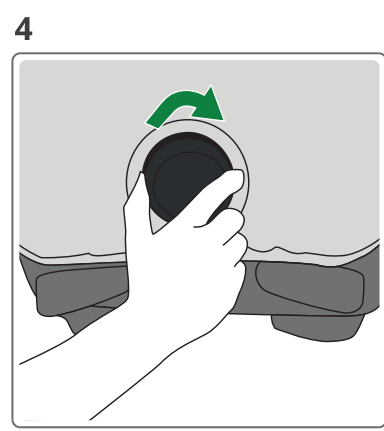

4-11

INDY

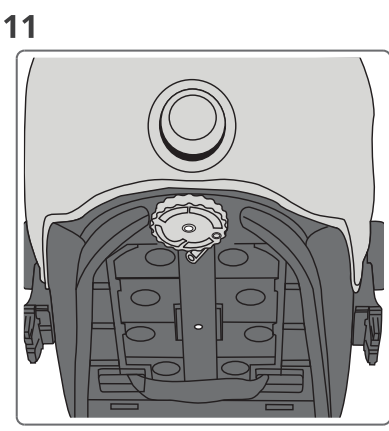
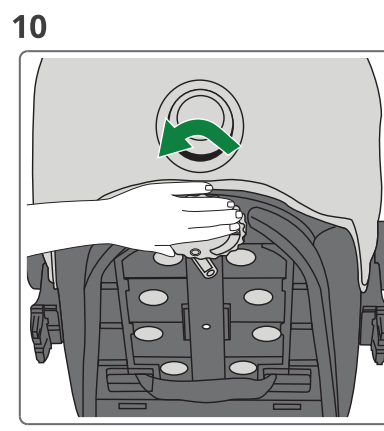

12-21

INDY

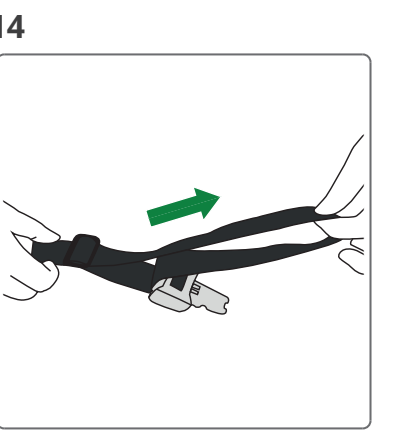
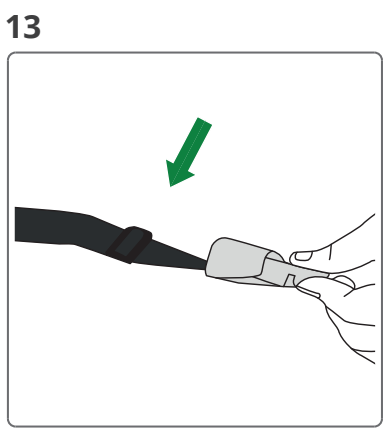
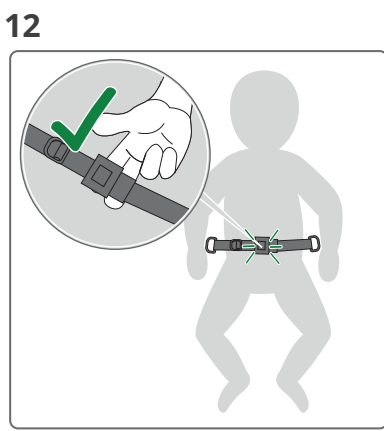

12-21

INDY

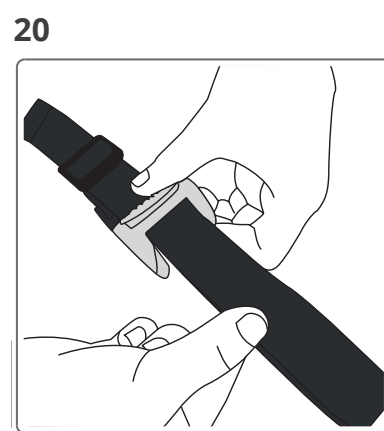
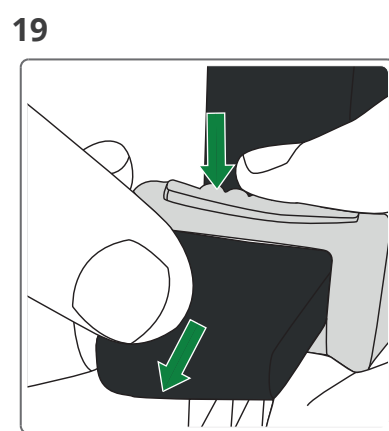
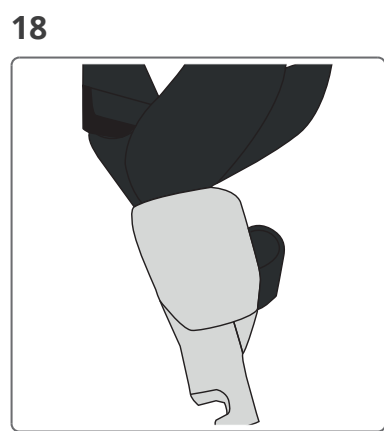

22-42

INDY

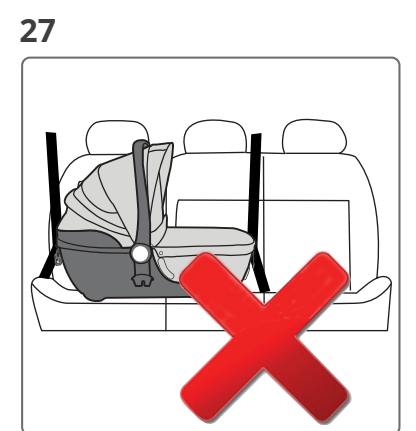
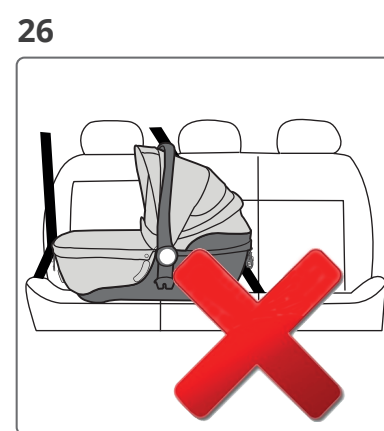
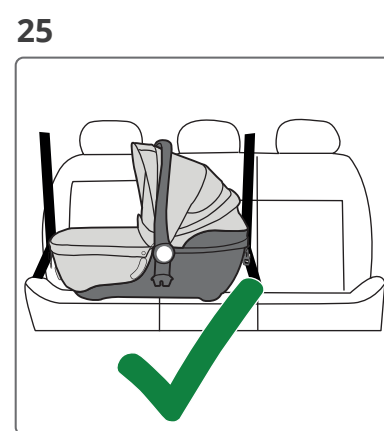
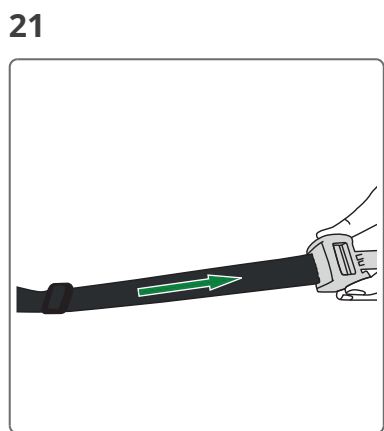
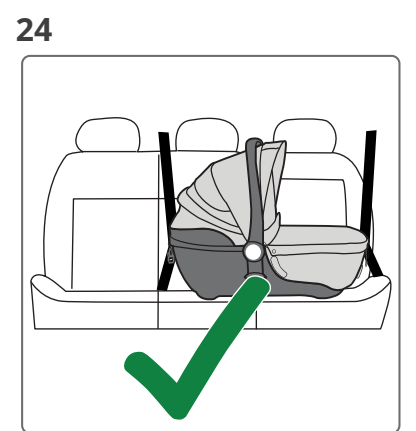
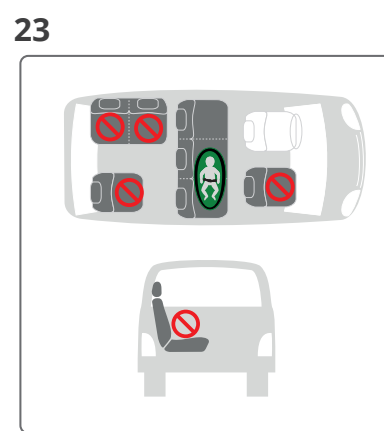
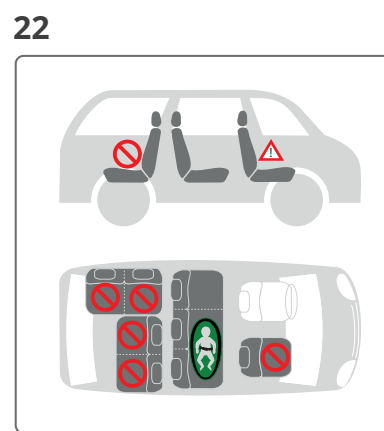

22-42

INDY

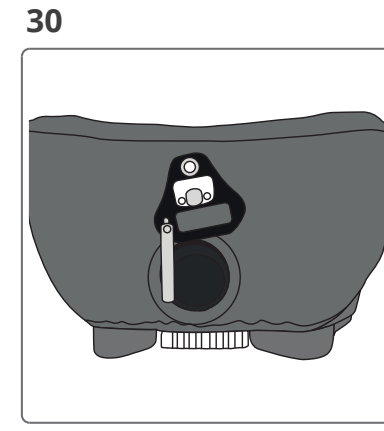
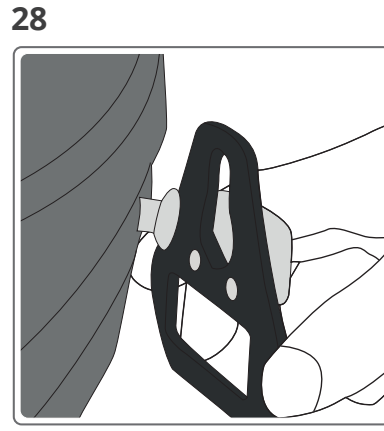

22-42

INDY

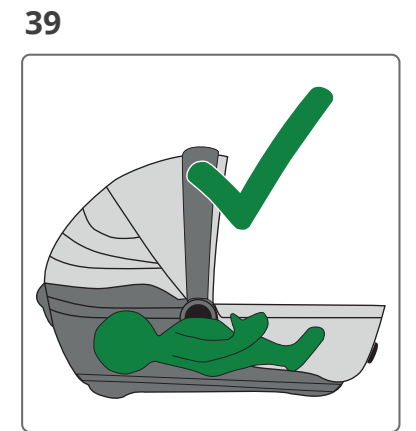
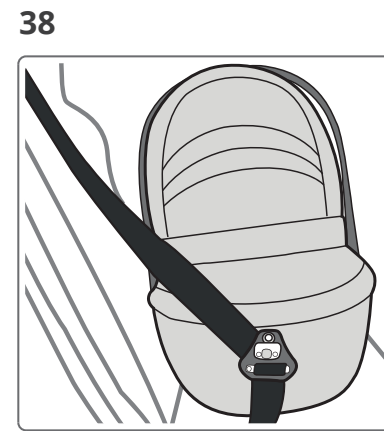
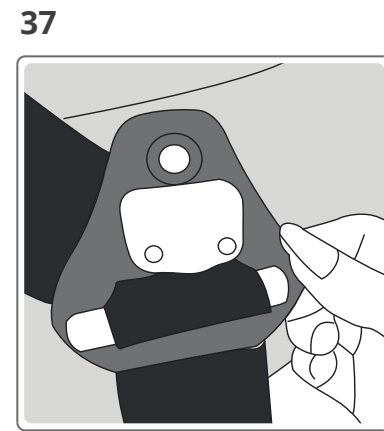
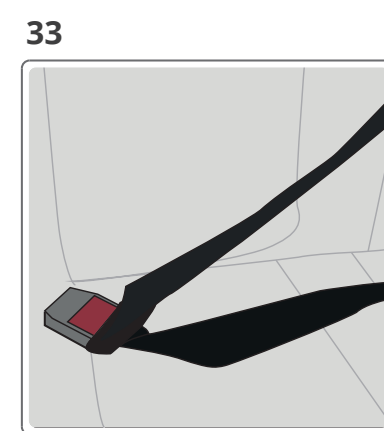
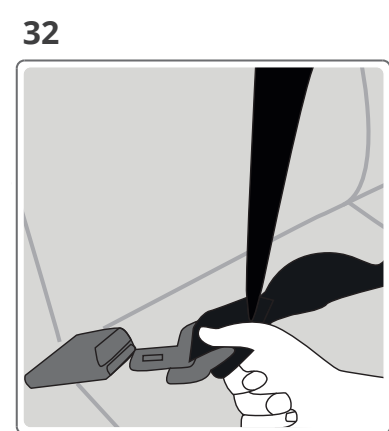
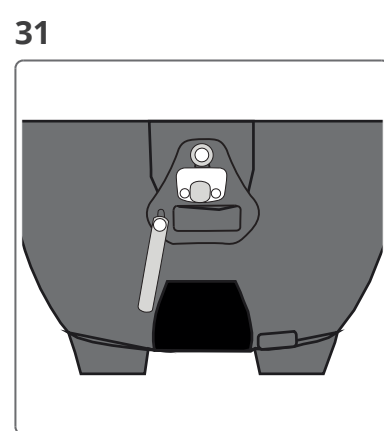
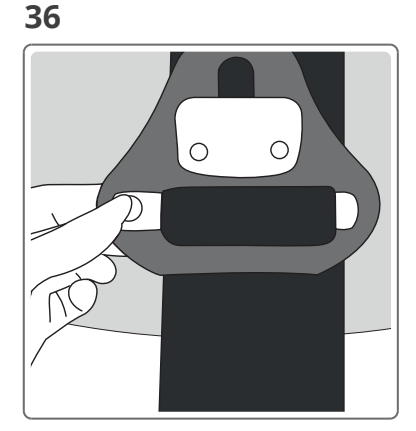
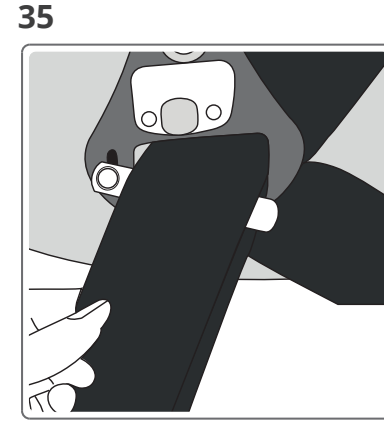
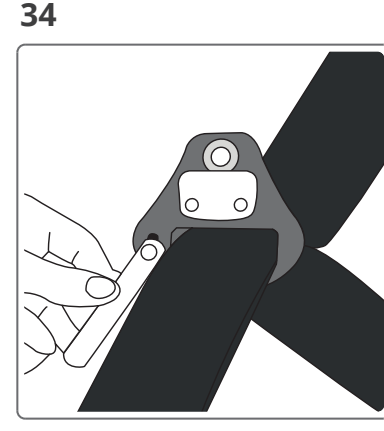

# SYMBOLE BILDERKLÄRUNG BUBBLE

DIN EN  
1888:2012  
DIN EN 1466

Der Kinderwagen Indy entspricht den strengen Richtlinien der EN 1888:2012 / EN 1466:2012 und gewährleistet Ihnen einen sicheren und komfortablen Transport Ihres Kindes.



# BUBBLE

## SYMBOLE



**VORBEREITEN** – Tragebügel – Kopfstütze – Belüftungssystem



**GURTSYSTEM VERWENDEN**



**EINBAU IM FAHRZEUG** – richtige Position – Wanne sichern und lösen



**KINDERWAGEN MIT WANNE** – Anbringen, Lösen



**ZUSAMMENLEGEN**

## BILDERKLÄRUNG

- A Tragebügel
- B Verdeck
- C Sicht- und Belüftungsfenster
- D Frischlufteinlässe
- E Tragebügelverstellung
- F Wannenkörper
- G Kinderwagenadapter
- H Entriegelungsknopf Kinderwagen
- I Belüftungssystem
- J Sonnenschild Verdeck
- K Windschutz
- L Gurtschnallenadapter
- M Entriegelungsknopf
- N Gurtschnalle
- O Liegeverstellung
- P Belüftungsregulierung

# SYMBOLS LEGEND BUBBLE

DIN EN  
1888:2012  
DIN EN 1466

The Indy pram meets the strict requirements of the EN 1888:2012 / EN 1466:2012 standard and guarantees safe and comfortable transport of your child.



# BUBBLE

## SYMBOLS



**SET-UP** – Carry handle - Headrest - Ventilation system



**USE HARNESS SYSTEM**



**INSTALLATION IN A VEHICLE** – correct position –  
Secure and release carrycot



**PRAM WITH CARRYCOT** – mount, release



**FOLD FRAME**

## LEGEND

- A Carry handle
- B Canopy
- C Window and ventilation
- D Ventilation inlets
- E Carry handle adjustment
- F Carrycot body
- G Pram adapter
- H Release button for pram
- I Ventilation system
- J Sun shield canopy
- K Wind protection
- L Buckle adapter
- M Release button
- N Buckle
- O Adjustment of lying position
- P Regulation of ventilation

FOLLOW US



Gesslein GmbH · Redwitzer Straße 33 · 96257 Redwitz

[www.gesslein-indy.de](http://www.gesslein-indy.de)

